

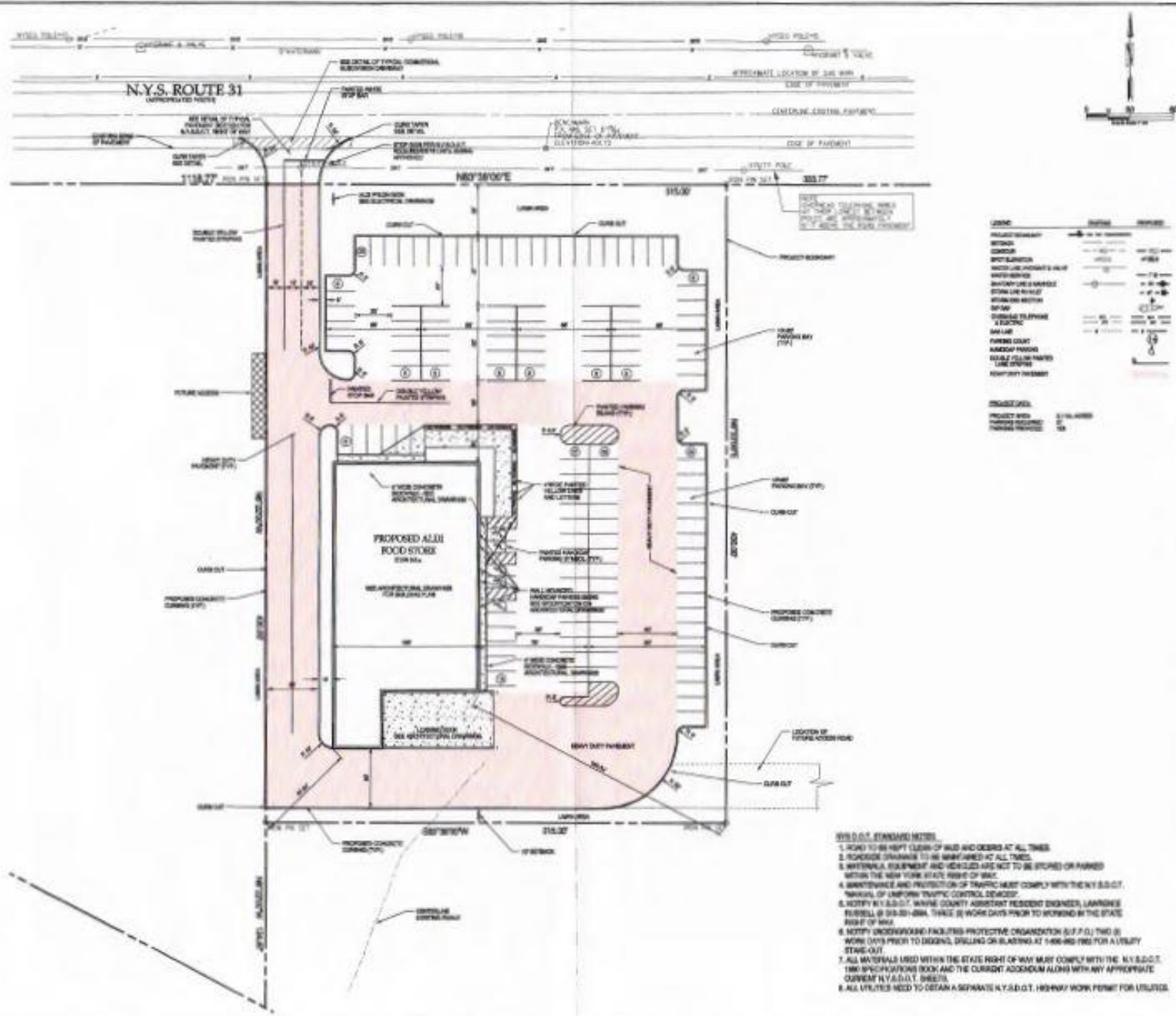

	1 mi radius		3 mi radius		5 mi radius	
<b>Population</b>						
Estimated Population (2013)	1,625		5,778		13,816	
Projected Population (2018)	1,667		5,922		14,169	
Census Population (2010)	1,618		5,760		13,766	
Census Population (2000)	1,630		5,934		14,189	
<i>Projected Annual Growth (2013 to 2018)</i>	41	0.5%	144	0.5%	353	0.5%
<i>Historical Annual Growth (2010 to 2013)</i>	7	0.1%	18	0.1%	51	0.1%
<i>Historical Annual Growth (2000 to 2010)</i>	-12	-0.1%	-174	-0.3%	-424	-0.3%
<b>Households</b>						
Estimated Households (2013)	692		2,342		5,552	
Projected Households (2018)	711		2,408		5,710	
Census Households (2010)	682		2,308		5,467	
Census Households (2000)	667		2,278		5,398	
<i>Projected Annual Growth (2013 to 2018)</i>	19	0.6%	66	0.6%	159	0.6%
<i>Historical Annual Growth (2010 to 2013)</i>	10	0.5%	35	0.5%	85	0.5%
<i>Historical Annual Growth (2000 to 2010)</i>	15	0.2%	30	0.1%	68	0.1%
<b>Average Household Income</b>						
Estimated Average Household Income (2013)	\$45,034		\$47,493		\$51,914	
Projected Average Household Income (2018)	\$50,608		\$52,021		\$56,173	
Census Average Household Income (2010)	\$39,566		\$43,922		\$47,637	
Census Average Household Income (2000)	\$38,083		\$43,092		\$43,409	
<i>Projected Annual Growth (2013 to 2018)</i>	\$5,574	2.5%	\$4,528	1.9%	\$4,258	1.6%
<i>Historical Annual Growth (2010 to 2013)</i>	\$5,469	4.6%	\$3,571	2.7%	\$4,277	3.0%
<i>Historical Annual Growth (2000 to 2010)</i>	\$1,483	0.4%	\$831	0.2%	\$4,228	1.0%
<b>Median Household Income</b>						
Estimated Median Household Income (2013)	\$32,590		\$38,988		\$44,554	
Projected Median Household Income (2018)	\$36,656		\$42,731		\$48,525	
Census Median Household Income (2010)	\$31,785		\$39,188		\$41,025	
Census Median Household Income (2000)	\$34,648		\$37,013		\$36,346	
<i>Projected Annual Growth (2013 to 2018)</i>	\$4,066	2.5%	\$3,743	1.9%	\$3,971	1.8%
<i>Historical Annual Growth (2010 to 2013)</i>	\$805	0.8%	-\$201	-0.2%	\$3,528	2.9%
<i>Historical Annual Growth (2000 to 2010)</i>	-\$2,864	-0.8%	\$2,175	0.6%	\$4,679	1.3%



NO.	REVISION	DATE
1	ISSUE FOR PERMIT	11/18/03
2	ISSUE FOR PERMIT	11/18/03
3	ISSUE FOR PERMIT	11/18/03
4	ISSUE FOR PERMIT	11/18/03
5	ISSUE FOR PERMIT	11/18/03
6		
7		

DATE	DATE
PROJECT NUMBER	DATE
PROJECT ENGINEER	DATE
PROJECT DESIGNER	DATE

Copyright © 2003  
 APD Engineering  
 340 Woods Plaza - Suite 808  
 Schenectady, NY 12302



**ALDI - LYONS**  
 ALDI, INC.  
 VILLAGE OF LYONS  
 WAYNE COUNTY  
 Project Name & Location

**SITE PLAN**

Drawing Name:	Project No.
Date:	96-0013
Type:	
Drawn By: MDP	S 1
Scale: 1"=30'	Drawing No.

- NY S.D.C.T. STANDARD NOTES**
- ROAD TO BE KEPT CLEAR OF PILES AND DEBRIS AT ALL TIMES.
  - EXPOSED DRINKING WATER SHALL BE KEPT AT ALL TIMES.
  - WATERWAYS, FISHWAYS AND VEGETATION ARE NOT TO BE SPREAD OR DAMAGED WITHIN THE NEW YORK STATE RIGHT-OF-WAY.
  - MAINTENANCE AND PROTECTION OF TRAFFIC MUST COMPLY WITH THE NY S.D.C.T. MANUAL OF UNIFORM TRAFFIC CONTROL DEVICES.
  - NOTIFY NY S.D.C.T., WAYNE COUNTY ASSISTANT RESIDENT ENGINEER, LAWRENCE BURELL @ 518-351-4884, THREE (3) WORK DAYS PRIOR TO WORKING IN THE STATE RIGHT-OF-WAY.
  - NOTIFY UNDERGROUND FACILITIES PROTECTIVE ORGANIZATION (U.F.P.O.) TWO (2) WORK DAYS PRIOR TO DIGGING, DRILLING OR BLASTING AT 518-662-7862 FOR A UTILITY STAKE-OUT.
  - ALL MATERIALS USED WITHIN THE STATE RIGHT-OF-WAY MUST COMPLY WITH THE NY S.D.C.T. 1985 SPECIFICATIONS BOOK AND THE CURRENT ADDENDUM ALONG WITH ANY APPROPRIATE CURRENT NY S.D.C.T. SHEETS.
  - ALL UTILITIES NEED TO OBTAIN A SEPARATE NY S.D.C.T. HIGHWAY WORK PERMIT FOR UTILITIES.