



Store #3842

Macedon, New York

425 NY State Route 31



Lot - 1.46 ± Acres
(Useable Acreage: 0.76 ± Acres)
\$250,000

FOR MORE INFORMATION CONTACT:

Tom Hornstein, Real Estate Broker
(315) 569-4345



3842
425 RT 31 Macedon, NY 14502

Legend

- Neighborhood Mkts
- Sam's Clubs
- DC's
- Once Occupied
- Once Occupied
- Shopping Centers
- Shopping Centers
- Retail Centers
- Restaurants
- Airports
- State Boundaries

Site Coordinates
 Longitude/X: -77.357045
 Latitude/Y: 43.066914

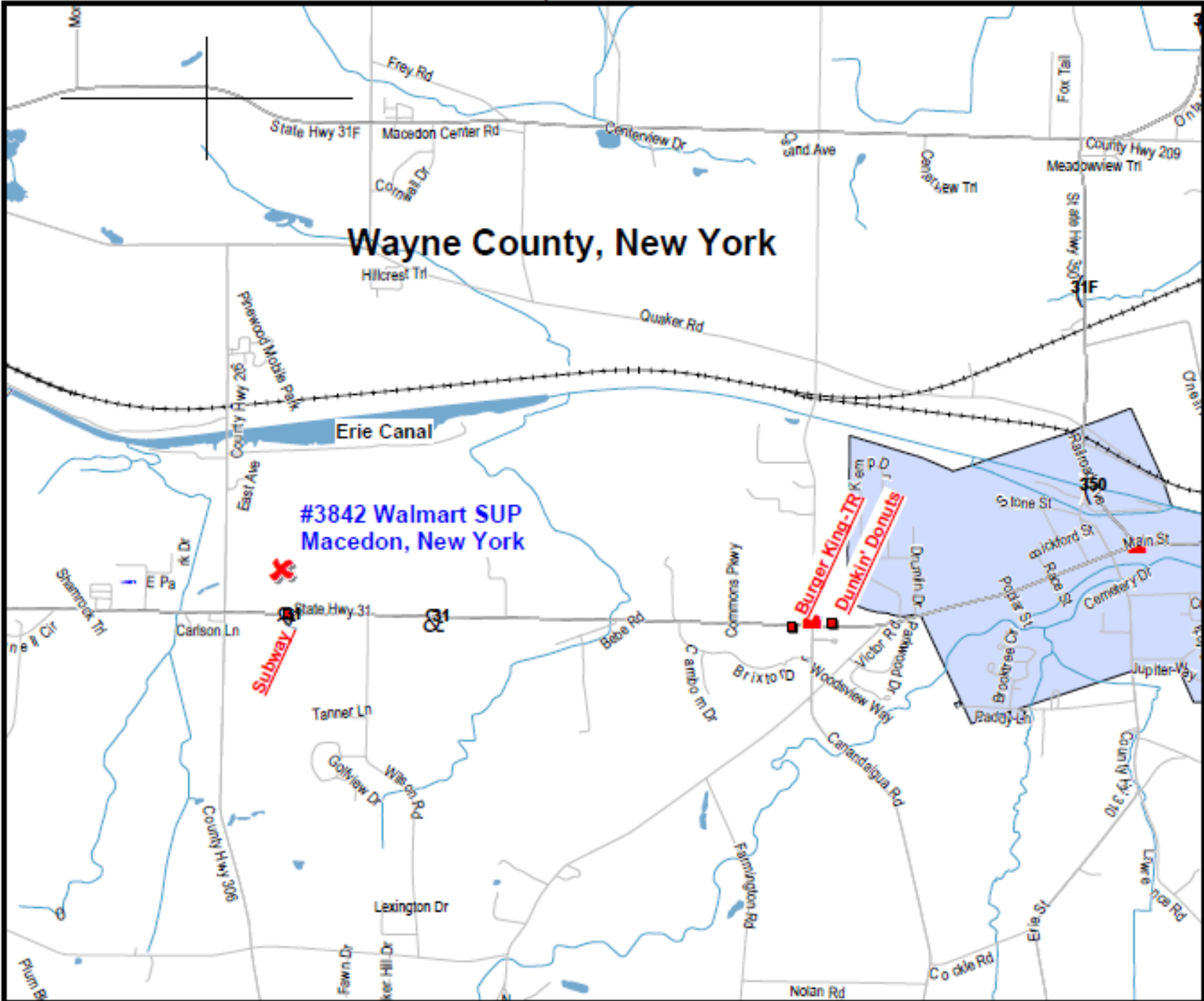

3842
425 RT 31 Macedon, NY 14502

Legend

- Neighborhood Mkts
- Sam's Clubs
- DC's
- Once Occupied
- Once Occupied
- Shopping Centers
- Shopping Centers
- Retail Centers
- Restaurants
- Airports
- State Boundaries

Site Coordinates
Longitude/X: -77.357045
Latitude/Y: 43.066914

Miles



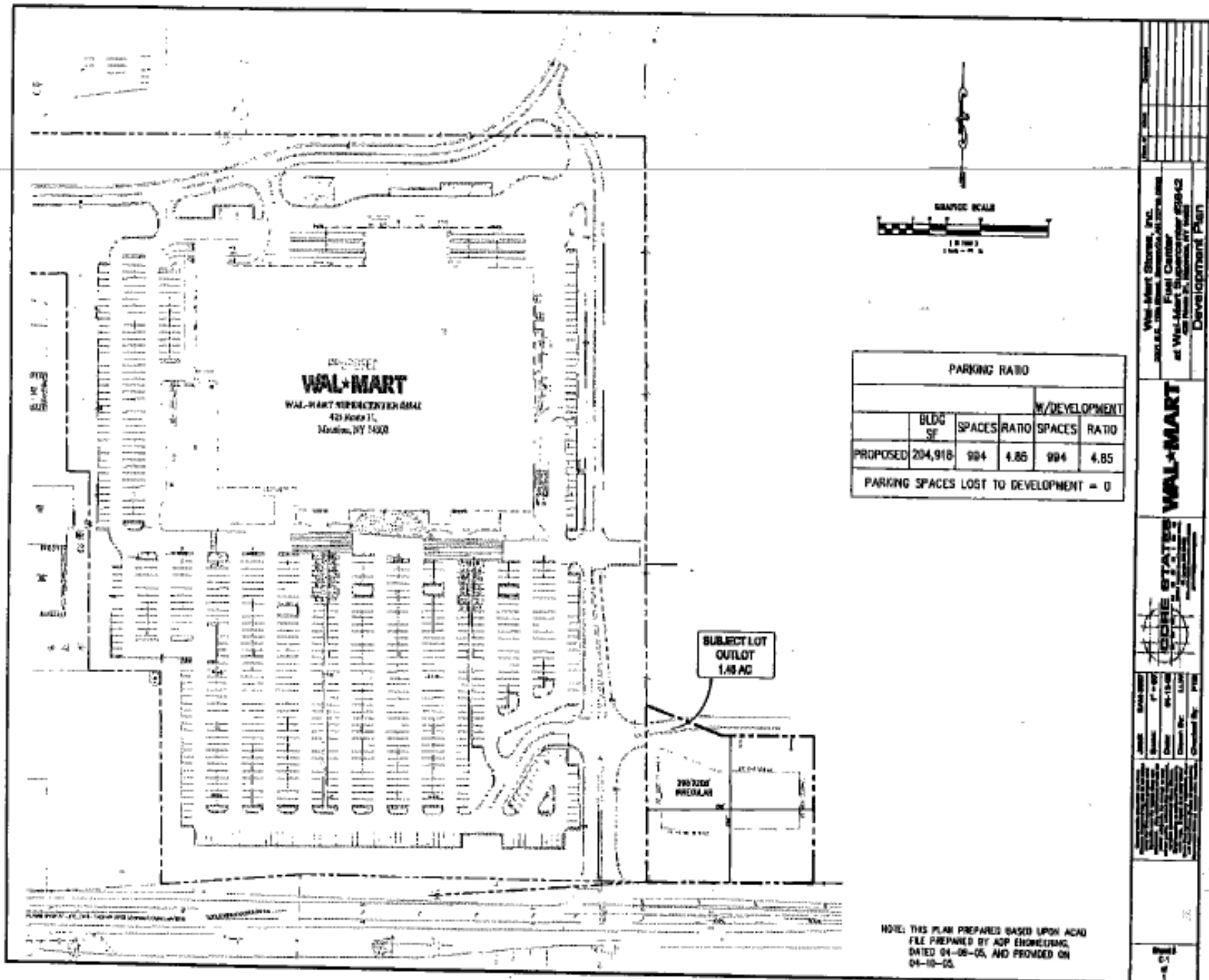

Wm. H. Horn & Co., Inc.
 200 S. 4th St., Rochester, NY 14602
 at Wal-Mart Supercenter #2042
 421 Road 11, Macedon, NY 14500
 Development Plan

WAL-MART

ISRIE STATES
 I, Isrie States, P.E., do hereby certify that I am a duly Licensed Professional Engineer in the State of New York, License No. 11111, and that I am the author of the above described plan.

Date: 04-10-05
 Scale: 1" = 100'
 Drawing No.: 11111
 Checked By:

Sheet
 of

NOTE: THIS PLAN PREPARED BASED UPON ACAD FILE PREPARED BY AGP ENGINEERING, DATED 04-08-05, AND PROVIDED ON 04-10-05.

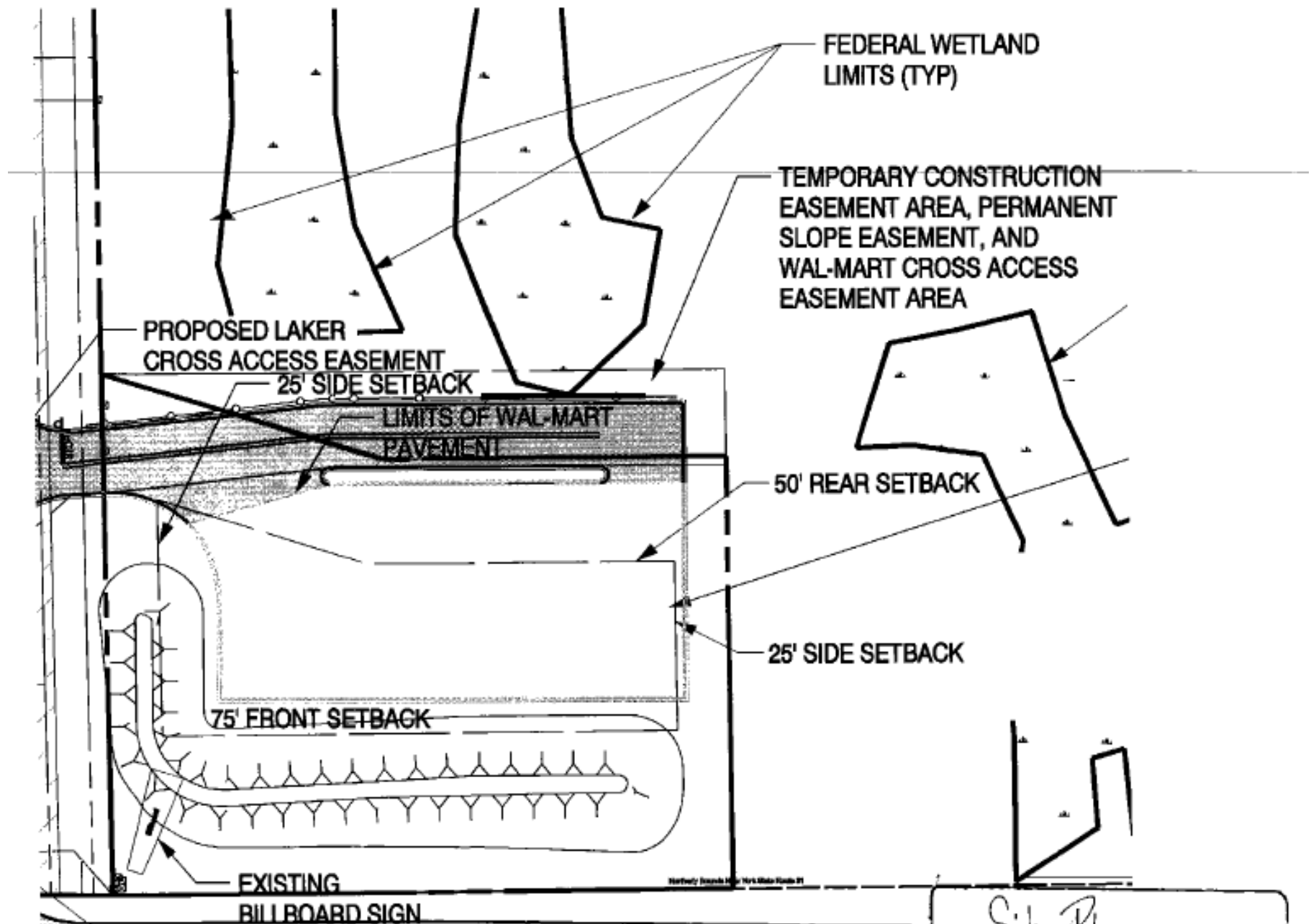

Site Plan
Macedon, NY